



IPL, MP635E, 9647702-10, 2005-12

# MP635E



**Factory:**  
**Product Group:**  
**Sub Group:**  
**Publication Date:**  
**Publication Number:**

**FLM - Newton Aycliffe**  
**OM 78**  
**Electric Wheeled: 7891**  
**01/12/05**  
**AP0512003**

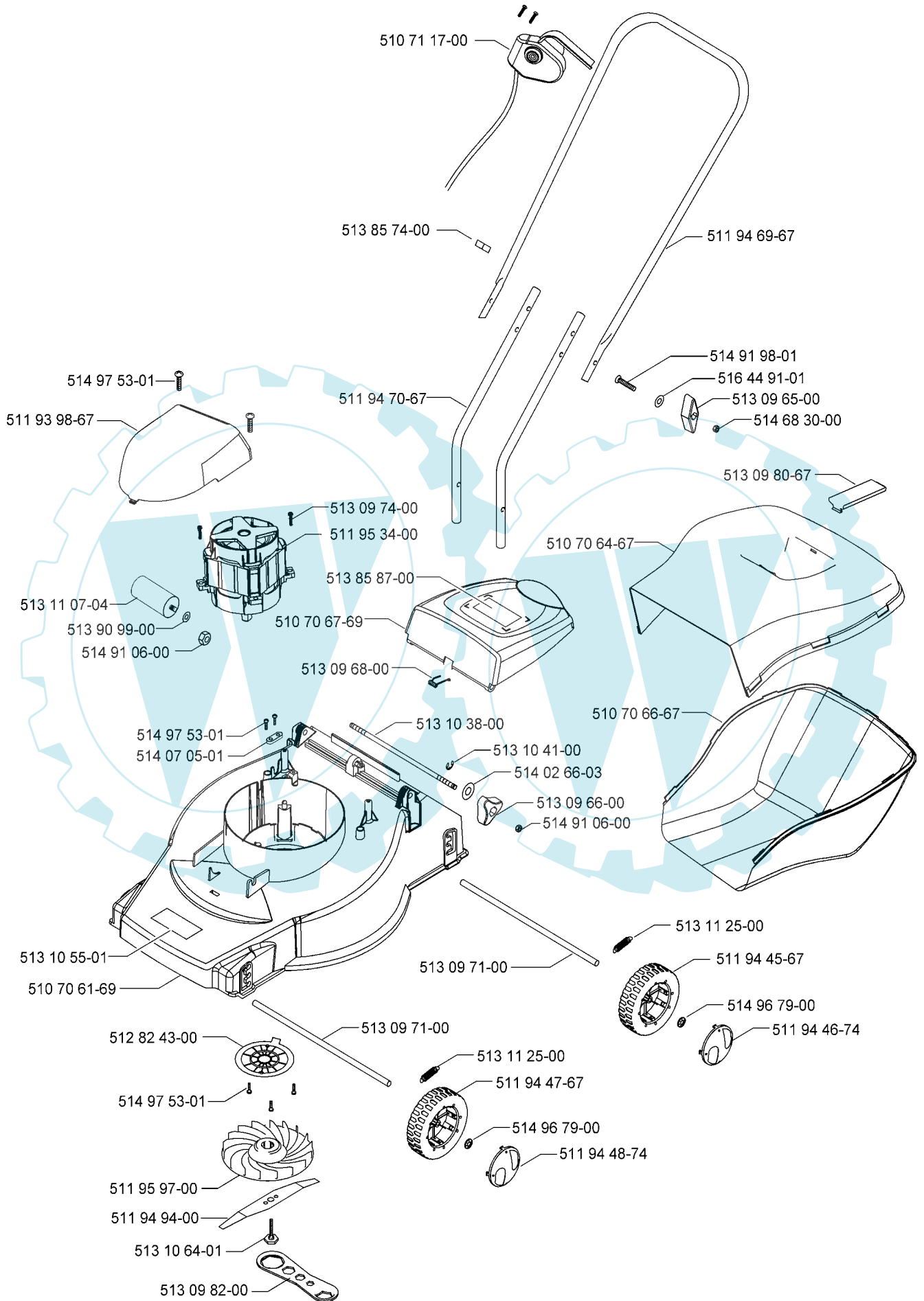

Part Number	Description	Qty	Note
510 70 61-69	DECK 33CM (YELLOW)	1	UK
510 70 64-67	GRASSBOX UPPER (BLACK)	1	
510 70 66-67	GRASSBOX LOWER (BLACK)	1	
510 70 67-69	SAFETY FLAP (YELLOW)	1	
510 71 17-00	SWITCHBOX VART EURO	1	
511 93 98-67	COVER MOTOR 635 BLACK	1	
511 94 45-67	WHEEL 6"	2	
511 94 46-74	HUB CAP 6"(GREY)	2	
511 94 47-67	WHEEL 5"	2	
511 94 48-74	HUB CAP 5"(GREY)	2	
511 94 69-67	HANDLE UPPER 33cm	1	
511 94 70-67	HANDLE LOWER(STICK BLACK)	2	
511 94 94-00	BLADE 33CM (MEP 10152890)	1	
511 95 34-00	MOTOR ATB INDUCTION	1	
511 95 97-00	IMPELLER 13 VANE 33CM	1	
512 82 43-00	FINGER PROTECTION PLATE	1	
513 09 65-00	WING KNOB M6 2 PRONG	2	
513 09 66-00	WING KNOB M8 3 PRONG	2	
513 09 68-00	SPRING SAFETY FLAP	1	
513 09 71-00	AXLE	2	
513 09 74-00	SCREW No12x25	2	
513 09 80-67	HANDLE GRASSBOX	1	
513 09 82-00	SPANNER METAL	1	
513 10 38-00	TIE ROD SAFETY FLAP	1	
513 10 41-00	E CLIP	2	
513 10 55-01	BRAND LABEL	1	
513 10 64-01	BLADE BOLT INSULATED (513117)	1	
513 11 25-00	SPRING:AXLE	4	
513 85 74-00	CABLE CLIP	2	
513 85 87-00	LABEL:WARNING (ELECTRIC)	1	
513 90 99-00	WASHER M8 INTERNAL TOOTH LOC	1	
514 02 66-03	WASHER	2	
514 07 05-01	CABLE CLAMP	1	
514 68 30-00	NUT M6 ZINC PLATED	2	
514 91 06-00	NUT M8	2	
514 91 06-00	NUT M8	1	
514 91 98-01	BOLT	2	
514 96 79-00	STARLOCK WASHER 8mm	4	
514 97 53-01	SCREW No8x3/4" POLYMATE	7	
516 44 91-01	WASHER	2	